

# NOUS

LIVING

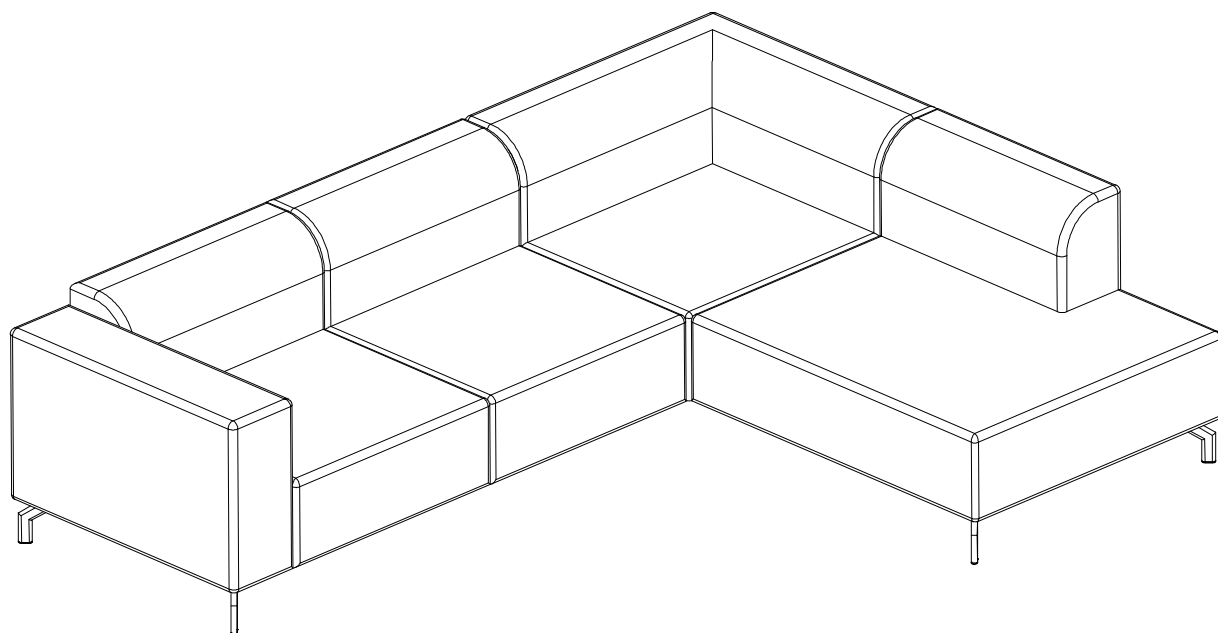

15 min



---

**BRENT 2,5+OE**

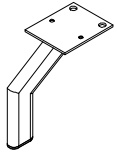

F1x6

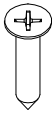

F2x12

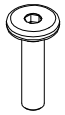

F3x12

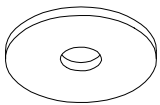

F4x1



F5x1

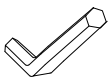

F6x1

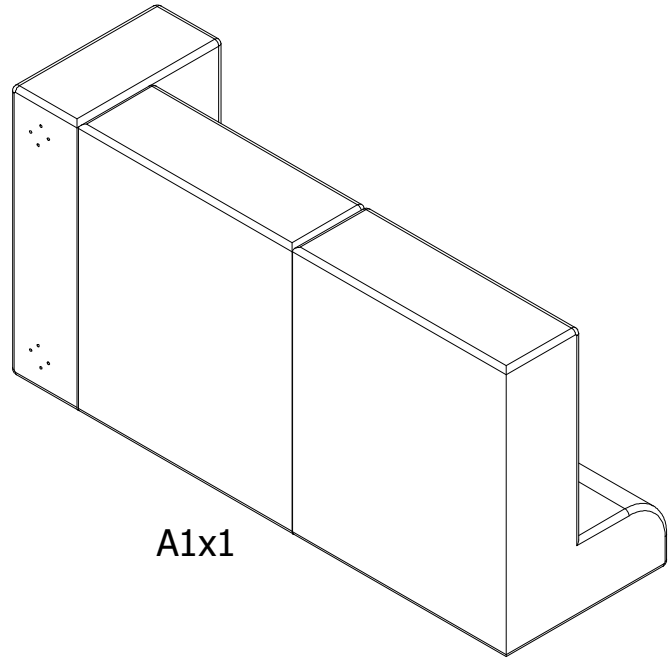

A1x1

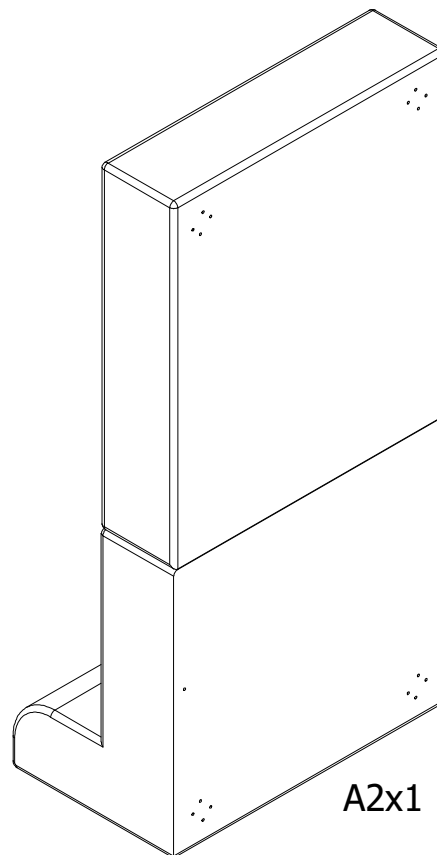

A2x1

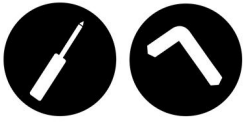

Draai de middelste pootjes niet helemaal tot aan de grond.  
Laat een ruimte van ongeveer 0,5cm tussen de pootjes en de vloer.

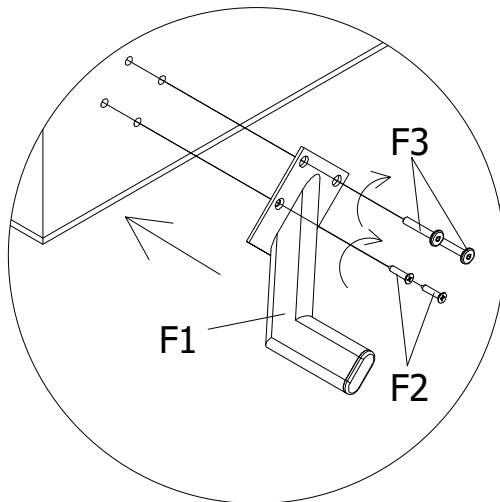
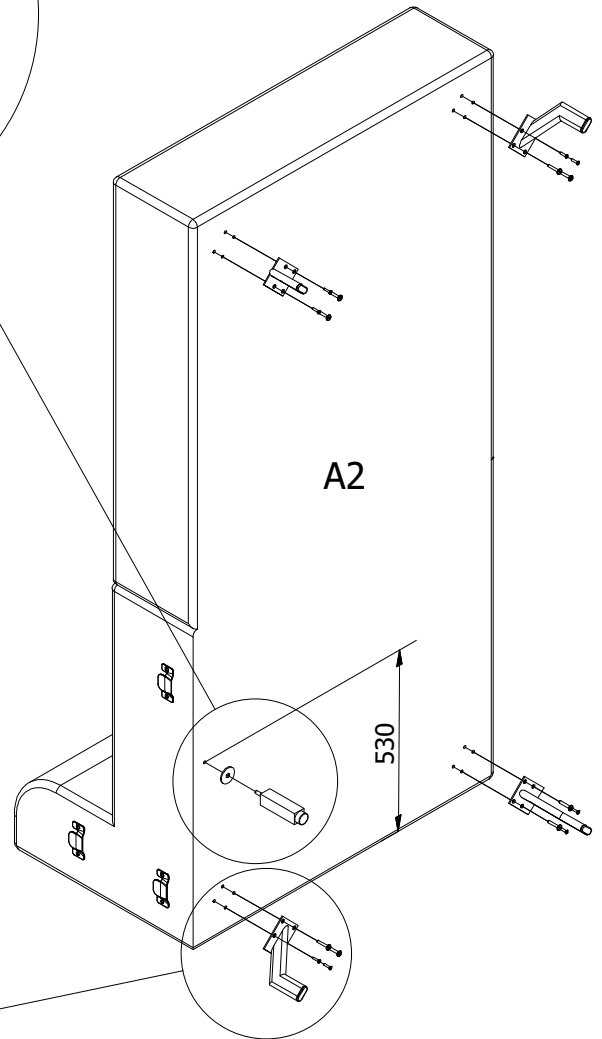
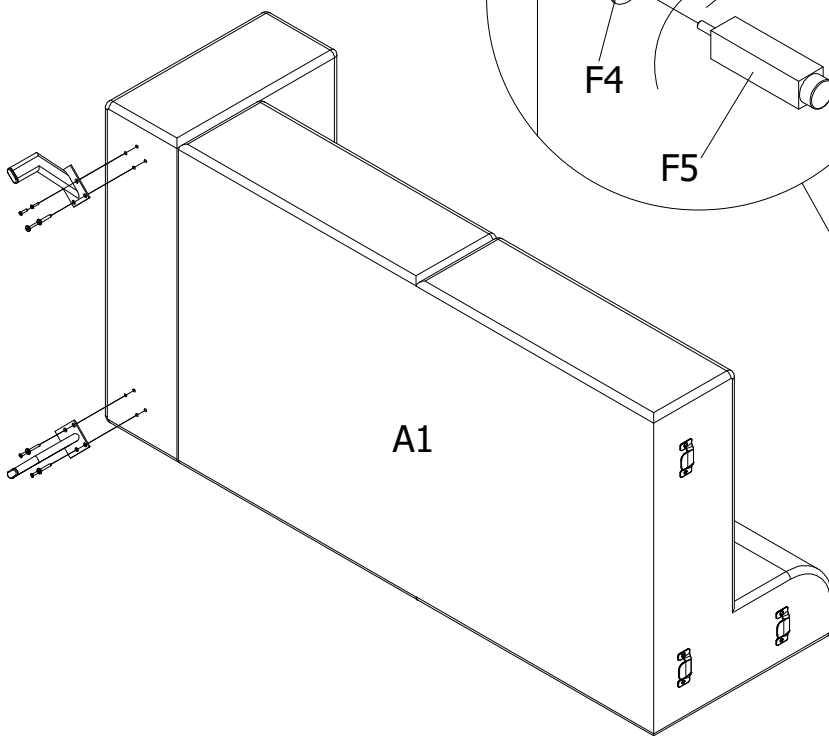
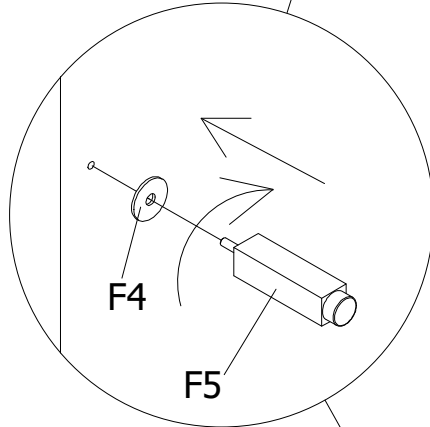
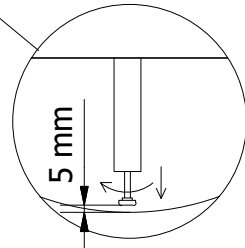
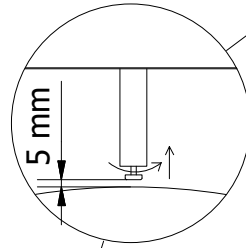

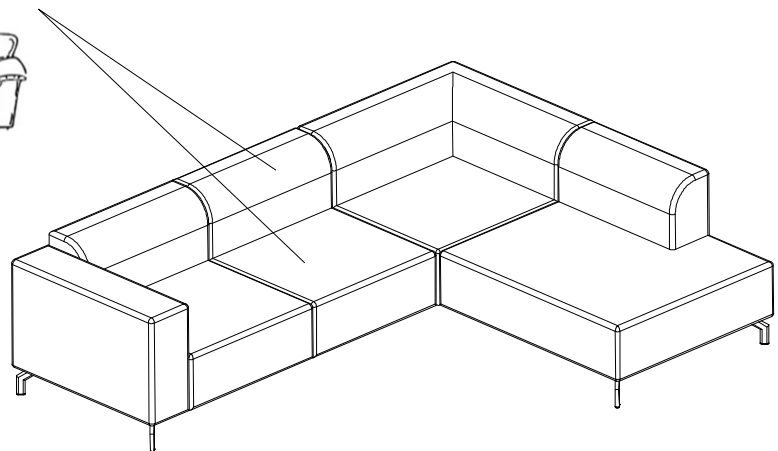
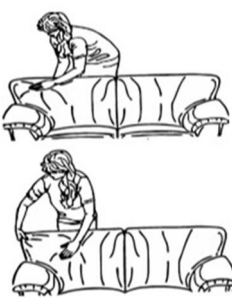
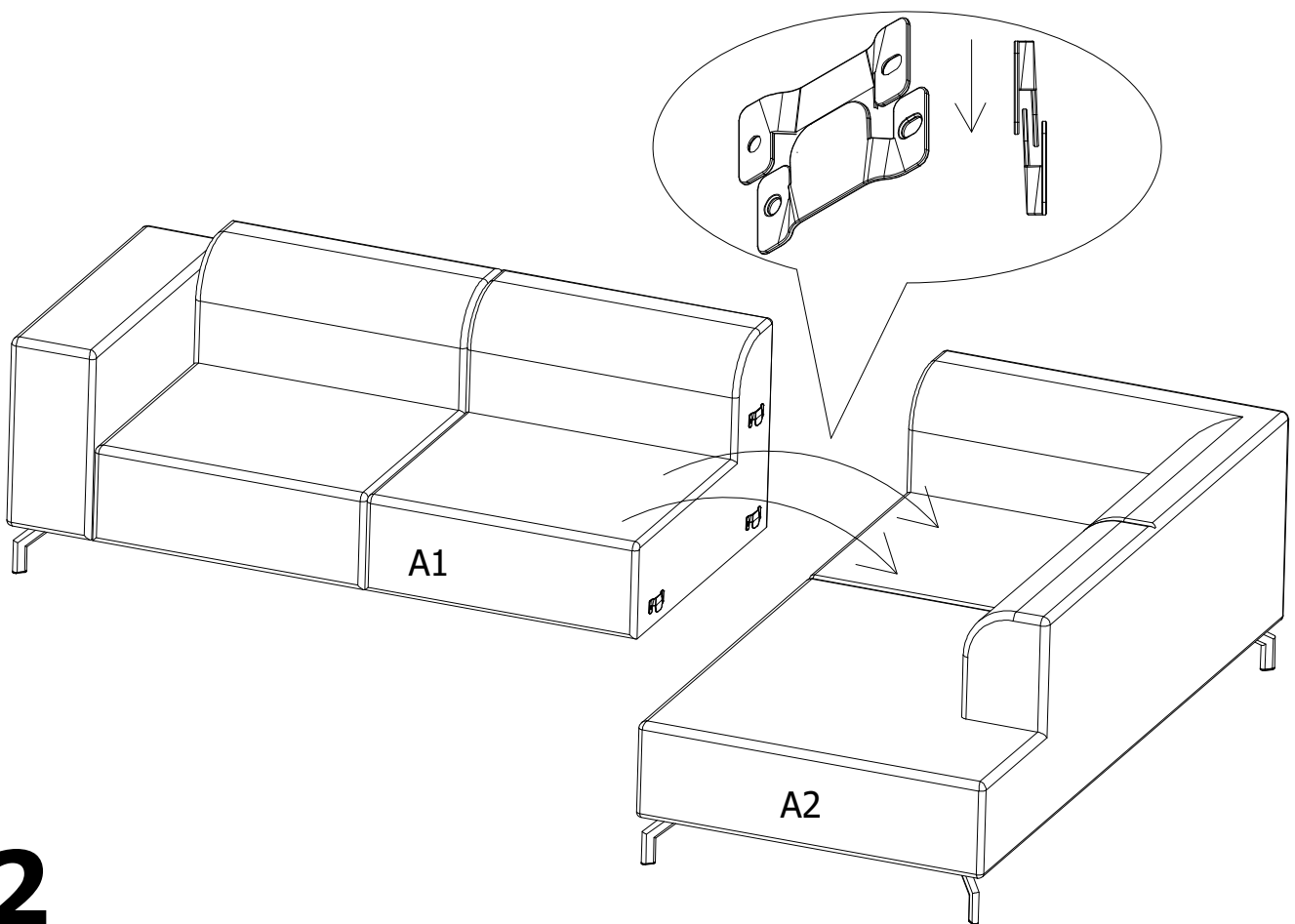

Nadat u het product bent gaan gebruiken, is het normaal dat er rimpels ontstaan, omdat er spanning ontstaat tijdens het zitten. Textielstof heeft meer kans om terug te krimpen in zijn vorm nadat er rimpels zijn ontstaan. Leren stof is stijver en krimpt niet snel terug. Het wordt aanbevolen om de stof één keer per week met de hand glad te maken en te egaliseren.